

BAG FILTER

ESS CORP.

Mod# BGX

1565 BRITANNIA RD. E. #36-37 MISSISSAUGA, ON. L4W 2V6 TEL: 905-696-9292 FAX: 905-696-8046

SPECIFICATIONS

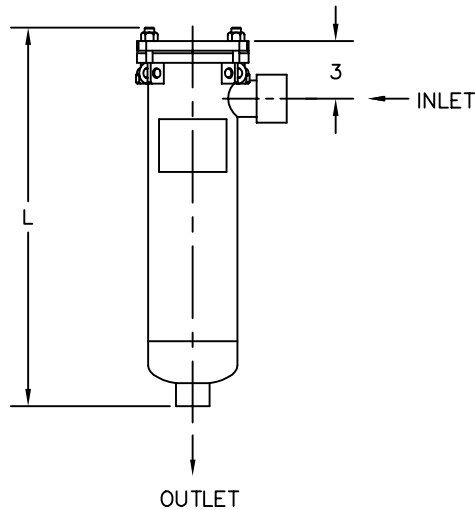
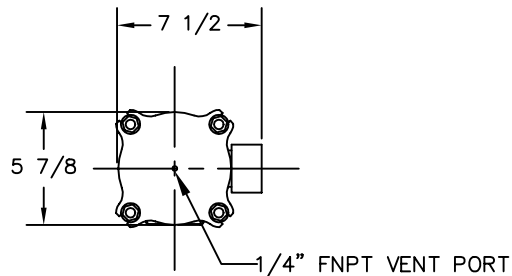

- Design Code ASME Sec. VIII Div. 1
- AVAILABLE MATERIAL: Carbon Steel, SS316/304, Titanium, Hastelloy.
- STANDARD DESIGN RATING: 150 PSIG @ 225 Deg. F, Other on Request
MIN. DESIGN METAL TEMP: -20 Deg. F. @ 150 PSIG, or Per Spec.
- BASKET: Size L1 or L2
Material: Stainless Steel
Perf. Plate, Dome Bottom
- FINISH: Blasted and Painted for CS
Glass Bead for SS Vessels, or to Meet Spec.
- INLET/OUTLET OPTION: RF Flange, Half Coupling, Other Available on Request
- EYE BOLTS AND HEX NUTS: Plated Carbon Steel
- Optional eye nuts available
- O'RINGS: Buna N or EPDM Standard
Viton, TEV or other optional
- Filter Bags Extra
- ASME Code Stamp Available
- Special Coating or High Polish Available on Request

MODEL	BASKET SIZE	CONNECTION	L (INCHES)
BGX-L1-1FNPT	L1	1" HALF CPLG.	17 1/8
BGX-L1-1 1/2FNPT	L1	1 1/2" HALF CPLG.	17 1/2
BGX-L1-1F	L1	1" FLG.	18 1/4
BGX-L1-1 1/2F	L1	1 1/2" FLG.	18 1/2
BGX-L2-1FNPT	L2	1" HALF CPLG.	21 1/8
BGX-L2-1 1/2FNPT	L2	1 1/2" HALF CPLG.	21 1/2
BGX-L2-1F	L2	1" FLG.	22 1/4
BGX-L2-1 1/2F	L2	1 1/2" FLG.	22 1/2